



KING COUNTY

1200 King County Courthouse
516 Third Avenue
Seattle, WA 98104

Signature Report

July 18, 2000

Ordinance 13899

Proposed No. 2000-0365.2

Sponsors Miller

1 AN ORDINANCE relating to the transfer of approximately
2 5.3 acres of land from Sammamish Plateau Sewer and
3 Water District to Northeast Sammamish Sewer and Water
4 District for the purpose of providing water and sewer
5 service to identified properties.
6
7

8 **STATEMENT OF FACTS:**

9 1. A notice of intention proposing the transfer of approximately 5.3 acres of
10 land from Sammamish Plateau Sewer and Water District to Northeast Sammamish
11 Sewer and Water District for the purpose of providing water and sanitary sewer service
12 to affected properties was filed with the county council effective June 7, 2000.

13 2. Sammamish Sewer and Water District has found the petition for transfer to
14 be sufficient and has concurred with the proposed transfer in Resolution No. 2596,
15 passed on May 15, 2000.

Ordinance 13899

16 3. Northeast Sammamish Sewer and Water District has found the petition for
17 transfer to be sufficient and has concurred with the proposed transfer in Resolution No.
18 3107, passed on May 4, 2000.

19 4. Northeast Sammamish Sewer and Water District filed a Determination of
20 Nonsignificance on the proposed transfer dated May 8, 2000.

21 5. The Utilities Technical Review Committee recommended county council
22 approval of the proposed transfer on June 21, 2000.

23 6. The county council held a public hearing on the seventeenth day of July,
24 2000 and has considered the criteria in RCW 57.02.040.

25 BE IT ORDAINED BY THE COUNCIL OF KING COUNTY:

26 SECTION 1. The transfer of approximately 5.3 acres from the Sammamish
27 Plateau Water and Sewer District to the Northeast Sammamish Sewer and Water District
28 for the purpose of providing water and sanitary sewer service to the properties described
29 in Attachment A of this ordinance is approved. This proposed transfer is consistent with
30 RCW 57.02.040.

31 SECTION 2. Northeast Sammamish Sewer and Water District is the appropriate
32 entity to serve the proposed transfer area.

Ordinance 13899

33

34

SECTION 3. Completion of this transfer does not constitute county approval or

35

disapproval of any other permits, certifications or actions necessary to provide service to

36

this transfer area.

37

Ordinance 13899 was introduced on 6/26/00 and passed by the Metropolitan King County Council on 7/17/00, by the following vote:

Yes: 9 - Mr. von Reichbauer, Ms. Fimia, Mr. Phillips, Mr. Pelz, Mr. McKenna, Ms. Sullivan, Mr. Nickels, Mr. Pullen and Mr. Vance

No: 0

Excused: 4 - Ms. Miller, Mr. Gossett, Ms. Hague and Mr. Irons

KING COUNTY COUNCIL
KING COUNTY, WASHINGTON

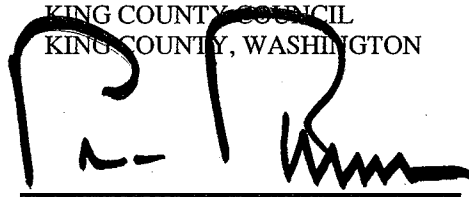

Pete von Reichbauer, Chair

ATTEST:

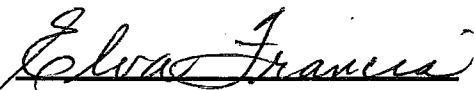

Anne Noris, Clerk of the Council

APPROVED this 27 day of July, 2000.



Ron Sims, County Executive

Attachments

A. Legal Description of Transfer Area, B. Map - Annexation 22

Legal Description of Transfer Area

Portion of the southeast $\frac{1}{4}$ of the southeast $\frac{1}{4}$ of Section 22, Township 25 North, Range 6 East, W.M. and the Northeast $\frac{1}{4}$ of the Northeast $\frac{1}{4}$ of Section 27, Township 25 North, Range 6 East, W.M. King County Washington described as follow:

Parcel 252706-9074-Sewer and Water Service

Beginning at the southeast corner of the southeast $\frac{1}{4}$ of Section 22, Township 25 North, Range 6 East, W.M.; thence west along said south line of said section 1,041.84 feet to the true point of beginning; thence N 02 degrees 05 minutes 09 seconds E 416.94 feet; thence N 89 degrees 38 minutes 03 seconds W 286.45 feet; then S 01 degrees 19 minutes 05 seconds W 416.94 feet; thence S 89 degrees 38 minutes 03 seconds E 218.84 feet to true point of beginning, situated in King County Washington.

Parcel 272506-9086-Sewer Service

The northwest $\frac{1}{4}$ of the southwest $\frac{1}{4}$ of the northeast $\frac{1}{4}$ of the northeast $\frac{1}{4}$ of Section 27, Township 25 North, Range 6 East, W.M., situated in King County Washington.

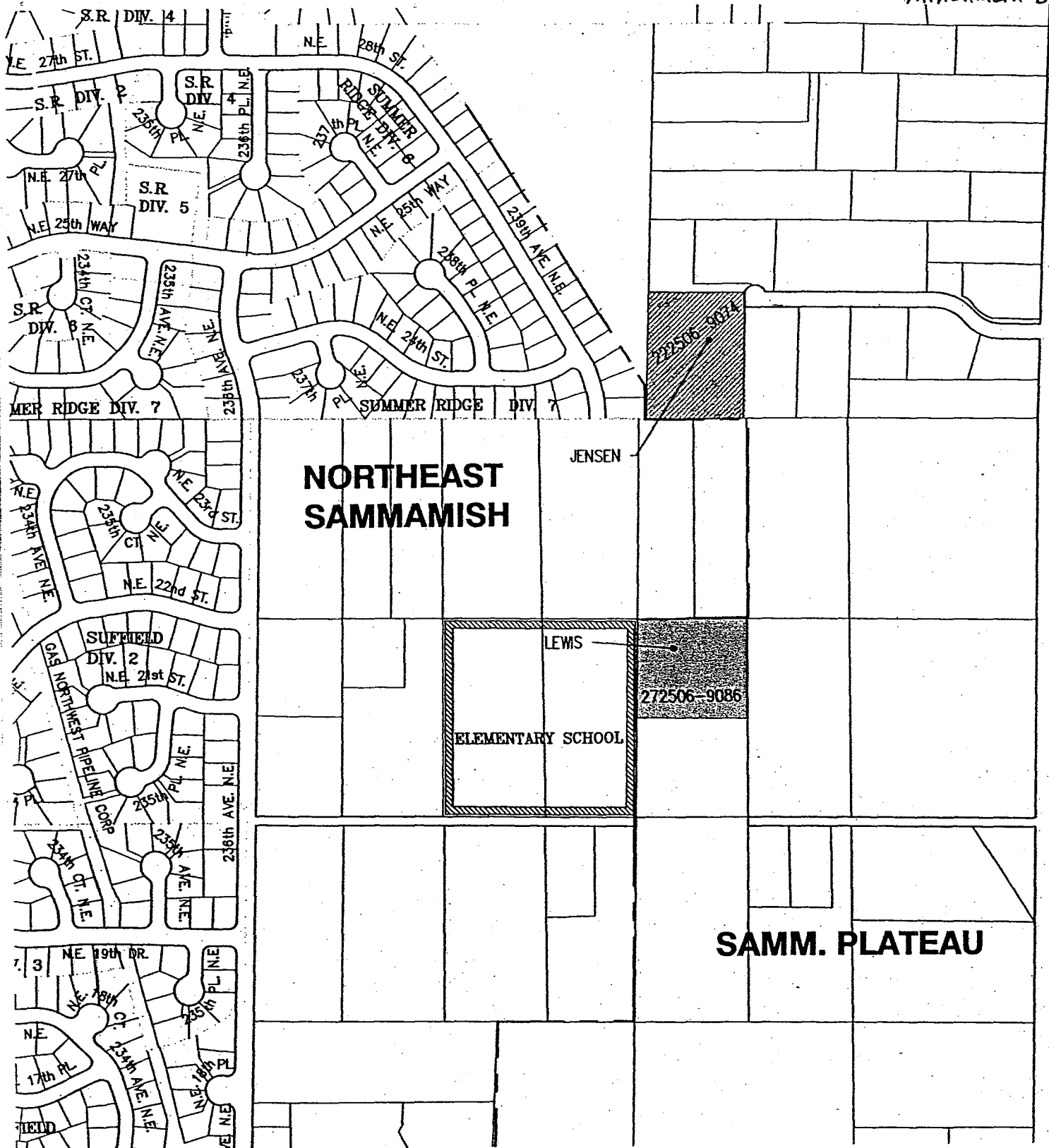

NORTHEAST SAMMAMISH

SAMM. PLATEAU

13899

PROPOSED TRANSFER AREA



ANNEXATION 22